

NO. A-23836-1

# PUMP PERFORMANCE CURVES

TYPE Submersible Sewage & Wastewater Pump	MODEL 150B47.5L -56 TOS150B47.5L -56	FREQUENCY 50 Hz
---	--	--------------------

CUSTOMER'S NAME \_\_\_\_\_

EQUIPMENT TITLE \_\_\_\_\_ NO. \_\_\_\_\_

	STANDARD SPECIFICATIONS	REQUIRED SPECIFICATIONS
DISCHARGE BORE	150 mm	mm
TOTAL HEAD	7.2 m	m
CAPACITY	4.0 m <sup>3</sup> /min	m <sup>3</sup> /min
MOTOR OUTPUT	7.5 kW	kW
PHASE × VOLTAGE	3 φ × V	φ × V
CURRENT	A	A
POLES / REVOLUTION	4 P / S. S. 1500 min <sup>-1</sup>	P / min <sup>-1</sup>
STARTING METHOD	DIRECT ON LINE	
INSULATION CLASS	F	

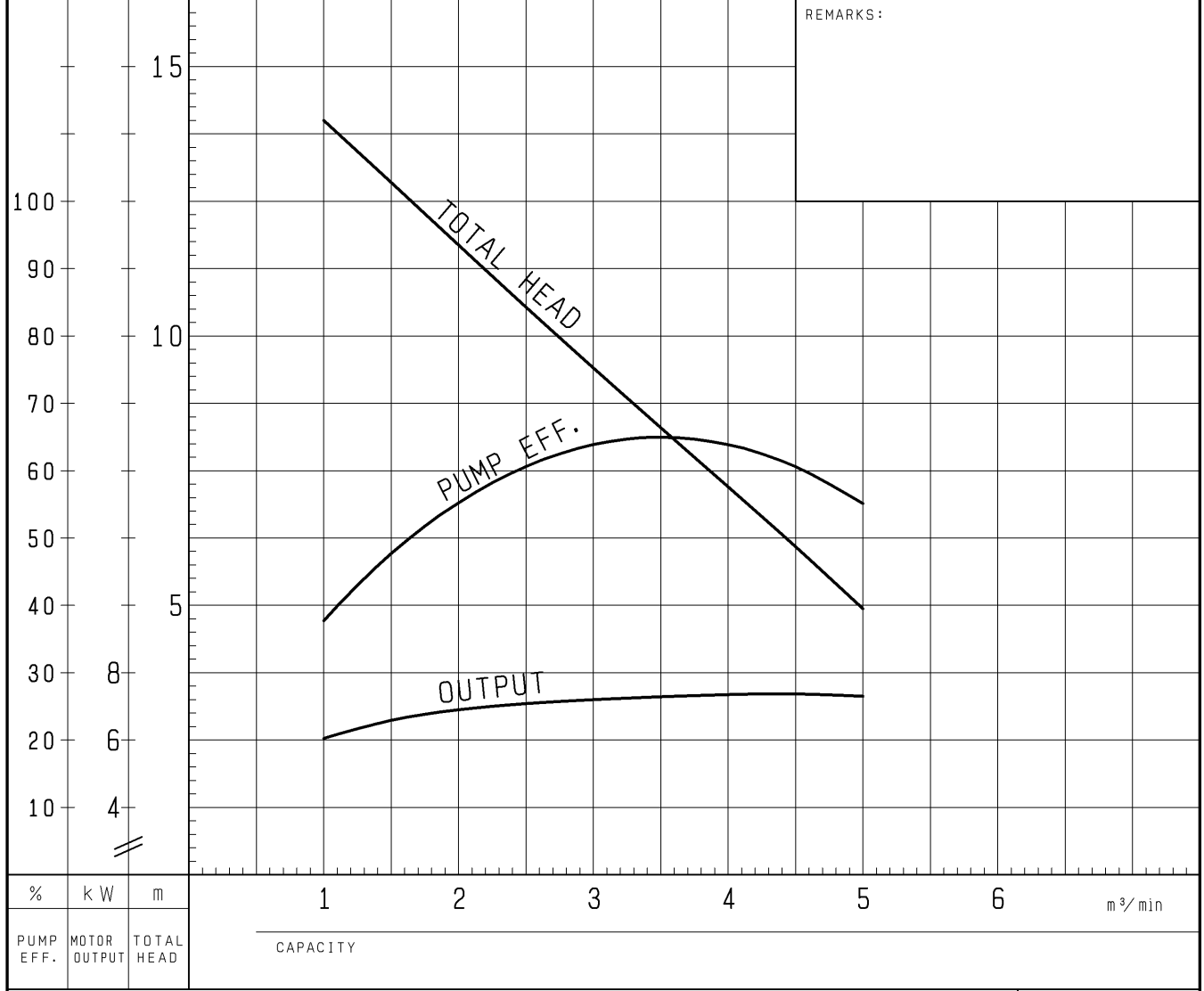

TSURUMI MFG. CO., LTD.

<b>DIMENSION DRAWING</b>		No.	No. A-23841-1
TYPE	Submersible Sewage & Wastewater Pump	MODEL	150B47.5L -56/66 200B47.5 -56/66

MODEL	Approximate Weight (kg)
150B47.5L-56/66	185kg
200B47.5-56/66	192kg

\*excluding cable

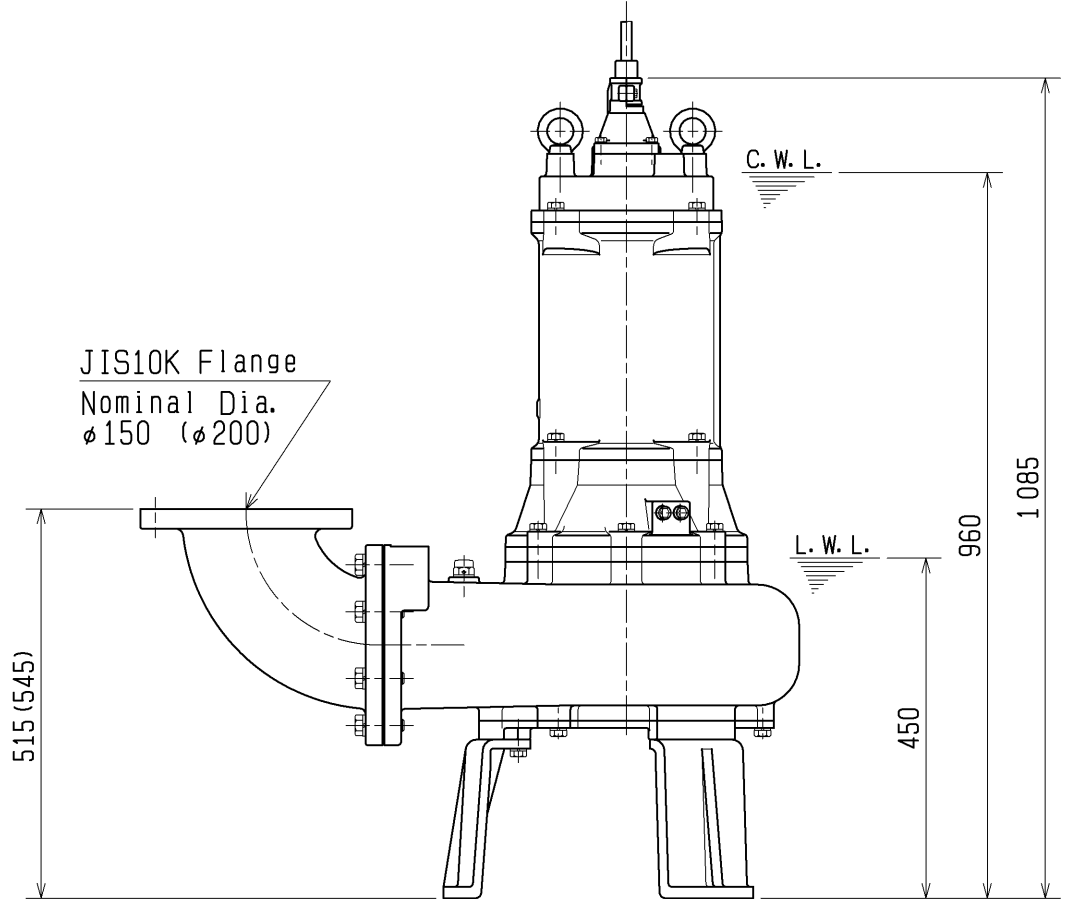
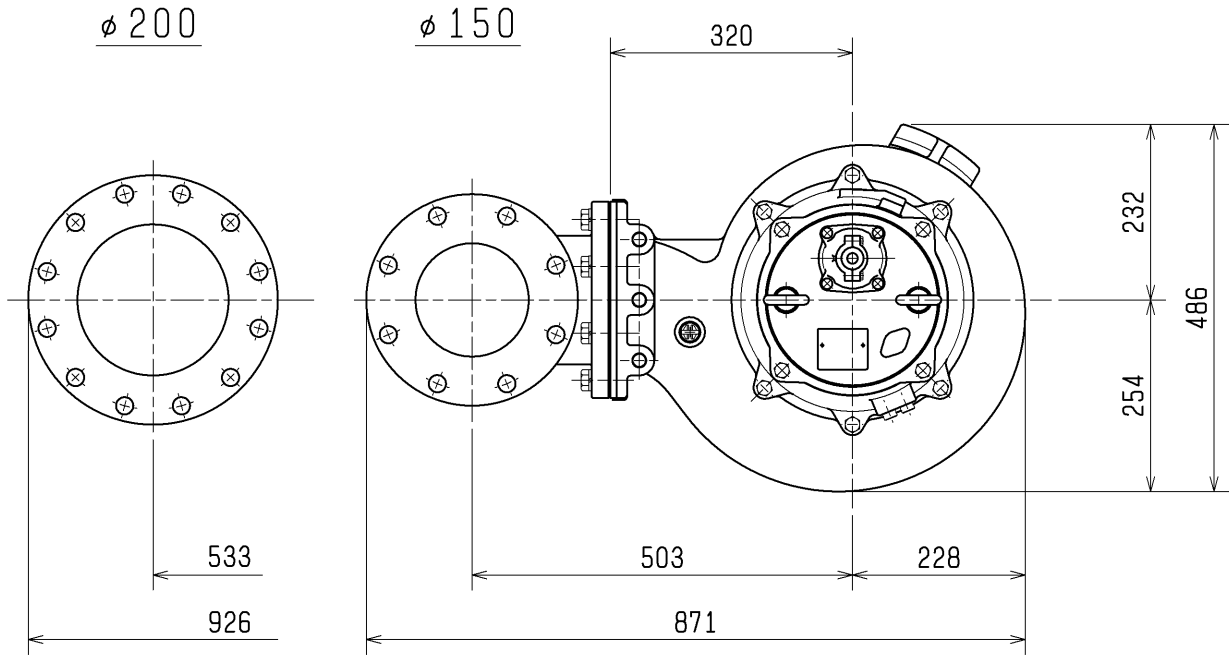

The Figure in ( ) shows the dimensions of '200B47.5'.

C. W. L. :Continuous running Water Level  
L. W. L. :Lowest running Water Level

<b>SECTIONAL DRAWING</b>		No.	No. A-23843-1
TYPE	Submersible Sewage & Wastewater Pump	MODEL	150B47.5L -56/66 200B47.5 -56/66

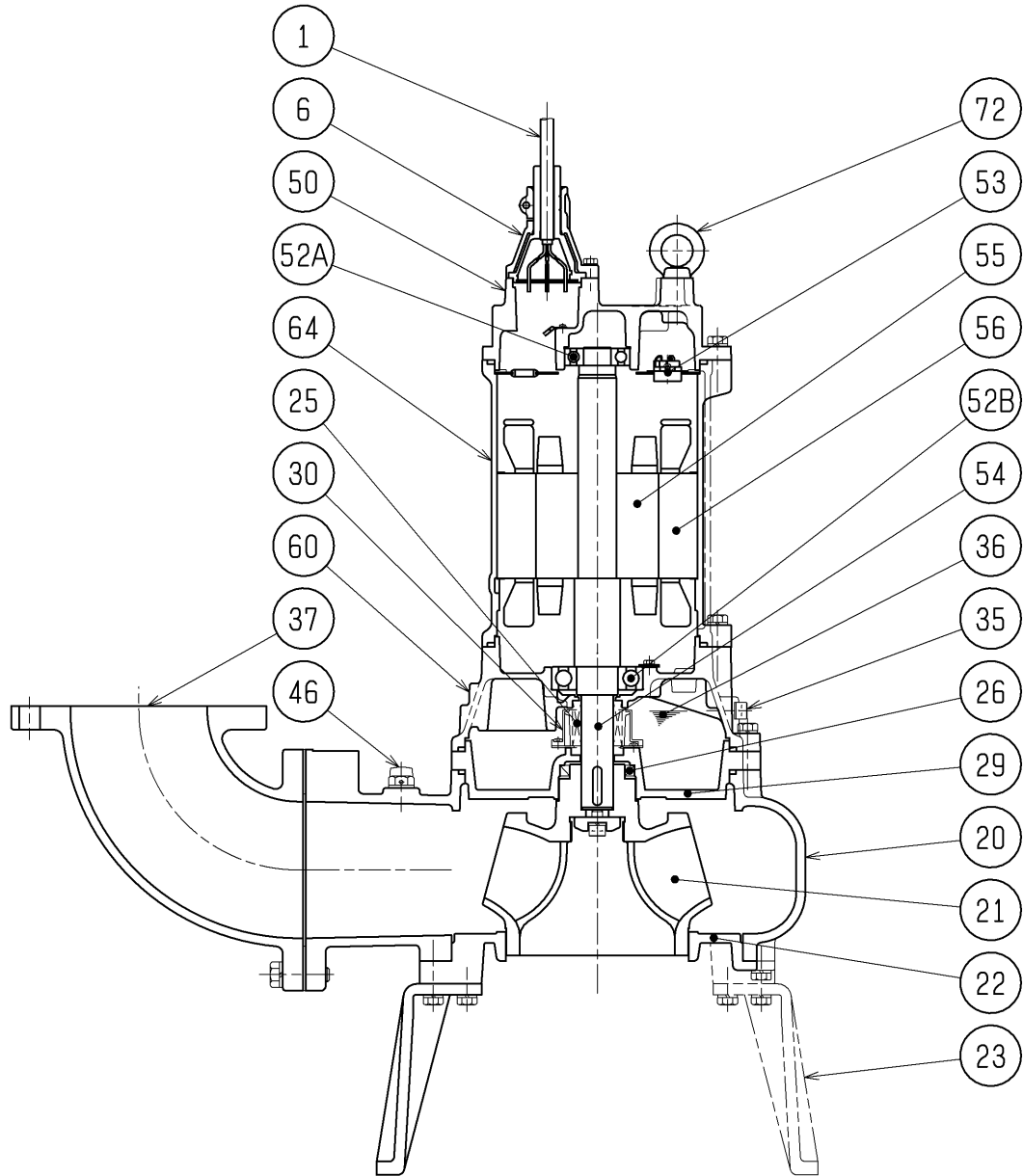

REQ. SPECIFICATION

No.	DESCRIPTION	Q'TY	MATERIAL / NOTE	No.	DESCRIPTION	Q'TY	MATERIAL / NOTE
1	Cable	1	Chloroprene Sheath	46	Air Release Valve	1	Nylon
6	Stuffing Box	1	Gray Iron Casting	50	Motor Bracket	1	Gray Iron Casting
20	Pump Casing	1	Gray Iron Casting	52A	Upper Bearing	1	6306ZZC3
21	Impeller	1	Gray Iron Casting	52B	Lower Bearing	1	6309ZZC3
22	Suction Cover	1	Gray Iron Casting	53	Motor Protector	1	
23	Stand	3	Ductile Iron Casting	54	Shaft	1	Stainless Steel 420J2
25	Mechanical Seal	1	H-35A	55	Rotor	1	
26	Oil Seal	1	TC608212	56	Stator	1	
29	Oil Casing	1	Gray Iron Casting	60	Bearing Housing	1	Gray Iron Casting
30	Oil Lifter	1	Plastic	64	Motor Frame	1	Gray Iron Casting
35	Oil Plug	2	Stainless Steel 304	72	Eyebolt	2	Structure Steel
36	Lubricant		Turbine Oil (ISO VG32)				
37	Discharge Bend	1	Gray Iron Casting				